

## Dimension

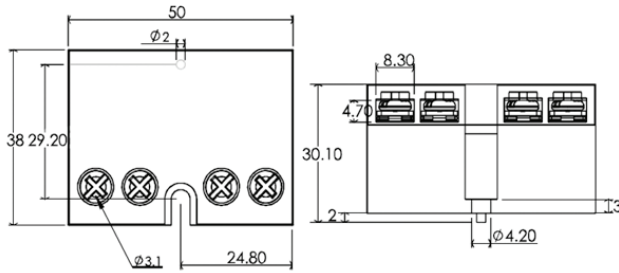

## Feature

Solid state rectifiers using semiconductors  
 Fast release time using a power MOSFET  
 (No external contacts are necessary)  
 MCU embedded

**Application** Hoists, Doors, Conveyers

**Approvals**  **RoHS**

## Selection guide

Rectifier mode	Operating current	-	Input voltage
HREC = Half wave	01 = 1.5A	-	220 = 220VAC
FREC = Full wave	03 = 3.0A	-	400 = 400VAC

## Electrical characteristics (Typical)

Parameter	HREC03-220	HREC03-400	Unit
Line voltage	200~240	360~440	VAC
DC output current	3.0	3.0	A
Cut-off voltage	160	300	VAC
Cut-off delay time (50Hz)	1.0	1.0	Cycle
Insulation voltage (between case and pins)	2500+	2500+	V
Insulation resistance (between case and pins)	10+	10+	M $\Omega$
Protection rating	IP20	IP20	-
Ambient temperature	-20/+60 °C	-20/+60 °C	°C
Housing material	UL94-V0	UL94-V0	-

## Wiring

